



Satellite Signal Meter
VF-6800P COMBO



USER'S MANUAL

FindSAT ≈ The Best SAT Finder

Digital Satellite Finder provides a simple and convenient solution for setting up satellite dishes. Using the programmed satellite parameters, you can quickly, easily and accurately align any satellite dish.

Function

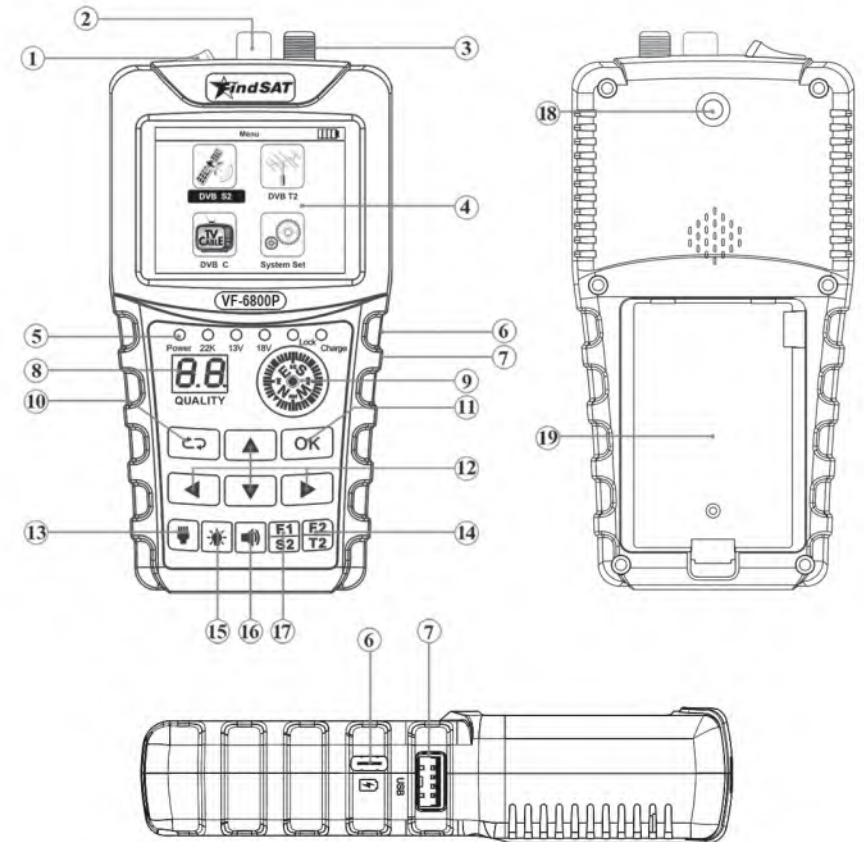

- (1) Switch
- (2) Ant input (T2/C)
- (3) LNB Input
- (4) LCD Screen
Displays satellite parameters and other technical.
- (5) Working status indicator
 - ①Power Light
Steady on: Power on state.
Blinking: The battery is in a low battery state, prompting to charge.
 - ②22K
Always on: Turn on the 22K switch.
 - ③13V、18V
Instructs the LNB to output the current working polarization voltage.
 - ④Lock
Steady on: signal lock status
Blinking: Prompt user LNB output short circuit
 - ⑤Charge Indicator
Steady red light: Charging
Steady green light: fully charged
Red and green flash simultaneously: battery failure
- (6) Type-C :Super Charge
- (7) USB port
Can update SW/ TP/Satellites list

- (8) Signal quality percentage display
- (9) The compass
- (10) Back button
Return to the previous menu key
- (11) OK button
Confirm current operation
- (12) Arrow keys
Up, down, left, and right buttons, press the button to move the cursor up, down, left, and right.
- (13) Torch control button
- (14) F2 shortcuts
Press the button to quickly enter the T2 signal search interface
- (15) Key's background light control button
- (16) Signal lock prompt tone control button
Press the button to turn the signal lock tone on or off
- (17) F1 shortcut keys
Press the button to quickly enter the S2 signal search interface
- (18) Lighting
- (19) Battery cover

THE MENU OPERATION

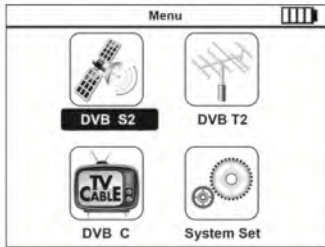

* The main interface

In the main interface, press the arrow keys to move the cursor position, press OK to enter the next level interface, press the return key to return to the previous level interface.

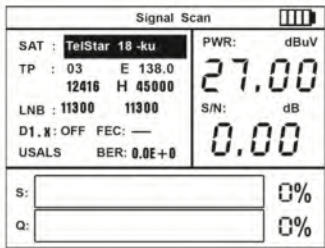

* Shortcut key F1

In the main interface, press the F1 shortcut key to quickly enter the S2 signal search interface.

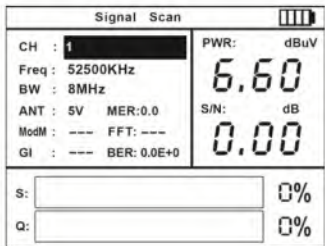

* Shortcut key F2

In the main interface, press the F2 shortcut key to quickly enter the S2 signal search interface.

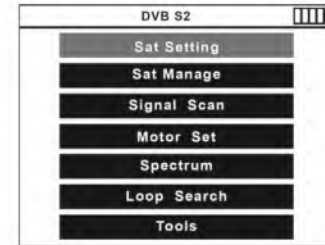

* Satellite management interface
On the DVB S2 interface, move the cursor to the sat manage and press OK to enter the sat manage interface.

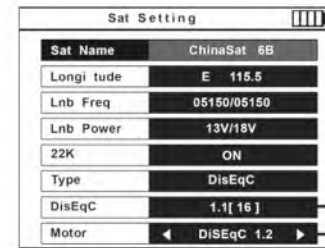

* DVB-S2 parameter setting
Sat Setting Interface, you can change the data information by ▲/▼ keys.

DisEqC1.0(1-4) / OFF / DisEqC1.1 (1-16)
OFF / USUAL / DisEqc1.2

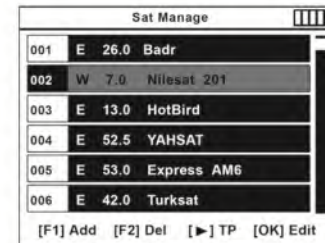

* Select satellite list interface
On the sat name, press left and right to enter the satellite list, press up and down to select the satellite to be searched, select OK and press OK to confirm

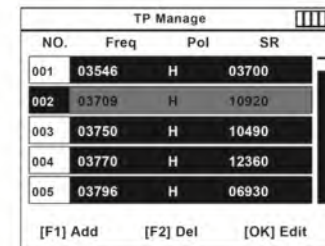

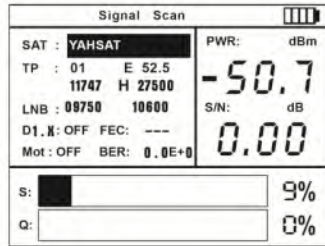

* DVB-S2 large window display signal interface

In the DVB-S2 search interface, press the OK button to enter the large window display signal.

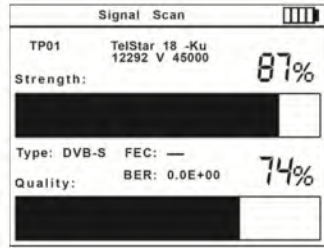
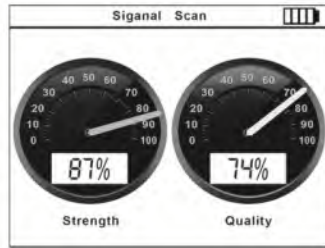

* satellite motor control interface

Motor control interface, support DiSeqc 1.2 /USALS control motor

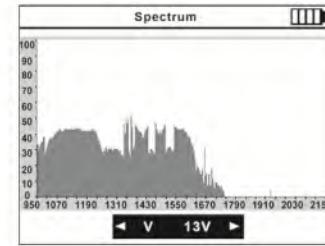
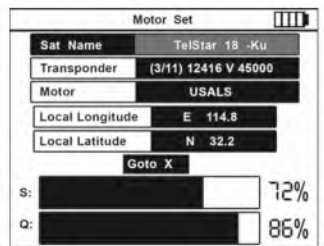
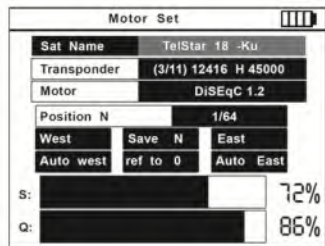

* The spectrum shows that in the 950-2150 mid band, the overall condition of the signal is shown.

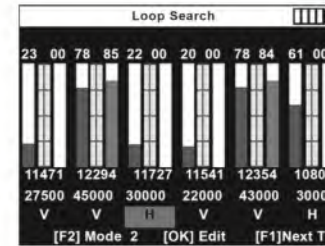

* Cyclic display of the signal status of each selected TP.

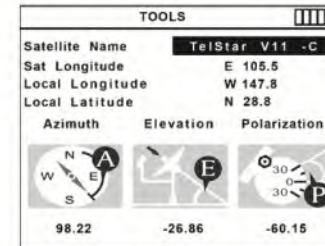

* In Tools, press OK to enter the satellite tool interface

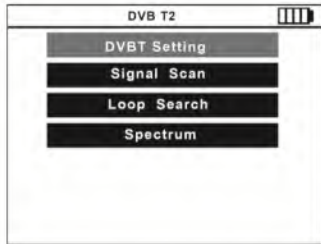

* **DVB-T2 parameter setting interface**
Under the DVBT Setting interface, you can select the country, channel, frequency, bandwidth, and antenna voltage. Use the arrow keys, OK button, and back button to operate.

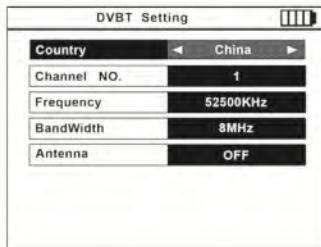

* Press OK to enter the DVB-T2 signal search interface, press the return button. Return to the previous interface.

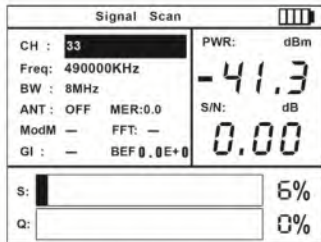

* In the DVB-T2 signal search interface, press the OK button to enter the large window display signal, such as the interface.

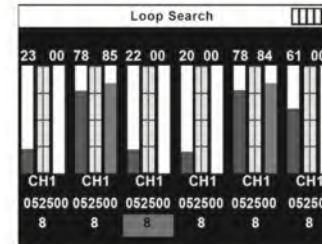
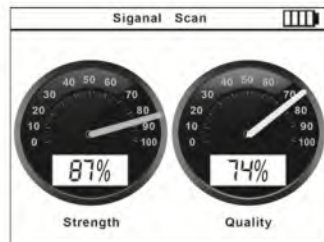
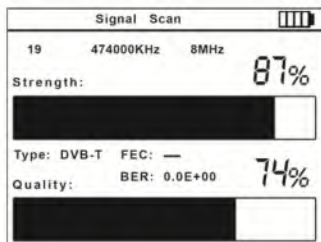

* Cycle through the signal status of each selected channel.

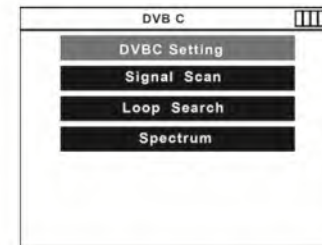

* **DVB-C parameter setting interface**
In the DVBC Setting interface, you can set the channel, frequency, and symbol rate. Use the arrow keys, OK button, and back button to operate.

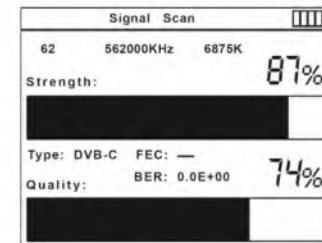
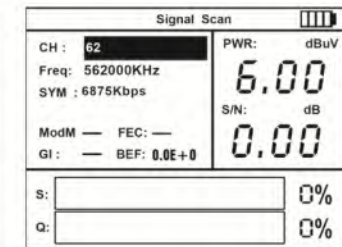
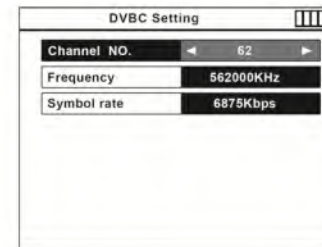

* Press OK to enter the DVB-C signal search interface, press the return button to return to the previous interface.

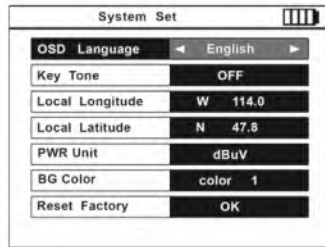

* System function interface

In the System set interface, you can set the OSD language, button tone switch, local longitude, local latitude, PWR unit, background color, restore default value, auxiliary tools, use the arrow keys, OK button, return button to operate.

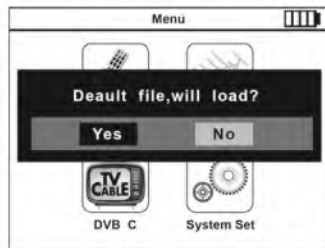

above is displayed.

* update satellite parameter interface

The satellite parameter file will be updated and copied into the USB flash drive. The USB flash drive is inserted into the USB interface of the device and the interface shown



* Select YES, as shown above, start the update. Do not turn off the power during the update process, and do not remove the USB flash drive.

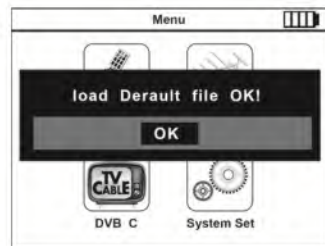

* After the update, as shown in the above interface, you can unplug the U disk and use the new satellite parameters to adjust the star.

Technical Specifications

- ★ 2.4" TFT Color LCD Screen
- ★ Fully Support DVB-S/DVB-S2、DVB-T/T2、DVB-C、MPEG2/MPEG4 Compliant
- ★ Support Spectrum Analyzer
- ★ Support Motor Set and antenna motor control --DiSeqC 1.2 /USALS/OFF
- ★ Support multiple OSD languages
- ★ Support 10 kinds of OSD interface color selection
- ★ Support DISEQC 1.0 / 1.1 / 1.2 and 22khz Tone
- ★ Test Content: Signal Strength , Quality , BER, PWR, SNR, MER ,etc
- ★ LNB short-circuit protection and indicator
- ★ Can support power for 0V/5V/12V--T/T2 antenna
- ★ Support low-voltage charging, can automatically wake up the sleep Battery
- ★ Audio alarm indicates signal intensity level
- ★ Signal lock audible notification: On/Off
- ★ Type-C :Super Charge

12 USER`S MANUAL

- ★ 7.4V/2500mAh Fast charging Li-ion battery , Ultra-long standby, low power consumption
- ★ With LED high brightness lighting
- ★ With Backlit Keys (On/Off)
- ★ With Compass and Power Switch
- ★ Edit Transponder : Edit , Add and Delete
- ★ SW update by Micro USB

ATT:

Due to the SW upgrade and update, the actual operation may be slightly different from the above description, please follow the instructions of the latest software interface

